



Education

**KwaZulu-Natal Department of Education
REPUBLIC OF SOUTH AFRICA**

MATHEMATICAL LITERACY P2

COMMON TEST

ADDENDUM

JUNE 2018

**NATIONAL
SENIOR CERTIFICATE**

GRADE 12

This Addendum consists of 6 pages with 5 Annexures.

ANNEXURE A

QUESTION 1.1

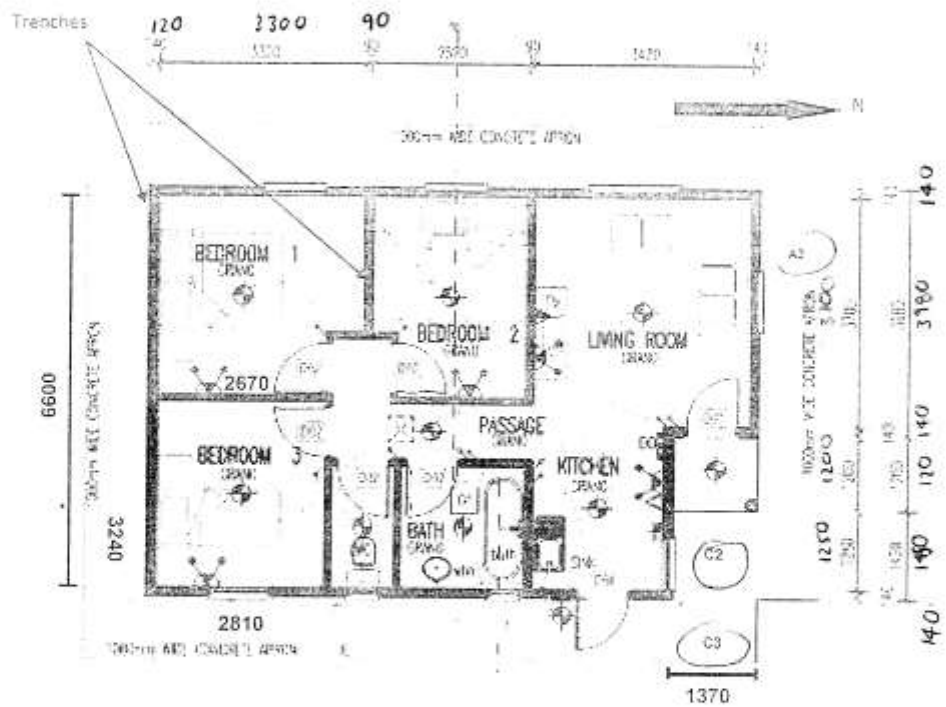

ANNEXURE B

QUESTION 1.2

Loan Amortization Schedule			
Loan Information		Summary	
Loan Amount (R)	100 000	Rate (per period)	0,583%
Annual Interest Rate	7,00%	Number of payments	172
Term of Loan in Years	15	Total Payments(R)	157 184,43
First Payment Date	01/01/2009	Total interest(R)	57 184,43
Payment Frequency	Monthly	Est. Interest Savings(R)	4 604,66
Compound Period	Monthly		

Monthly Payment R898,83

NO	Due Date	Payment (R)	Additional Payment (R)	Interest (R)	Principal	Balance (R)
						100 000,00
1.	01/01/2009	898,83		583,33	334,68	99 684,50
2.	02/01/2009	898,83		581,43	317,34	99 367,16
3.	03/01/2009	898,83		579,84	319,19	99 047,97
4.	04/01/2009	898,83	500,00	577,78	821,05	98 226,92
5.	05/01/2009	898,83		572,99	325,84	97 901,08
6.	06/01/2009	898,83		571,09	327,74	97 573,34
7.	07/01/2009	898,83	200,00	569,18	529,85	97 043,63
8.	08/01/2009	898,83		566,09	332,74	96 710,95
9.	09/01/2009	898,83		564,15	334,68	96 376,27
10.	10/01/2009	898,83	200,00	562,19	536,64	95 839,63
11.	11/01/2009	898,83		559,06	339,77	95 499,86
12.	12/01/2009	898,83		557,08	341,75	95 158,11
13.	01/01/2010	898,83		555,09	343,74	94 814,37
14.	02/01/2010	898,83		553,08	345,75	94 468,62
15.	03/01/2010	898,83		551,07	347,76	94 120,86
16.	04/01/2010	898,83	2000,00	549,04	2 349,79	91 771,07
17.	05/01/2010	898,83		535,33	363,50	91 407,57
18.	06/01/2010	898,83		533,08	365,62	91 041,95
19.	07/01/2010	898,83		531,08	367,75	90 674,20
20.	08/01/2010	898,83		528,93	369,90	90 304,30
21.	09/01/2010	898,83		526,78	372,05	89 932,25

ANNEXURE C

QUESTION 2.1

TABLE 1:

Mid-year population estimates for South Africa by population group and sex, 2017

Population group	Male		Female		Total	
	Number	% distribution of males	Number	% distribution of females	Number	% distribution of total
Black African	22 311 400	80,8	23 345 000	80,8	45 656 400	80,8
Coloured	2 403 400	8,7	2 559 500	8,9	4 962 900	8,8
Indian/Asian	719 300	2,6	689 800	2,4	1 409 100	2,5
White	2 186 500	7,9	2 307 100	8,0	4 493 500	8,0
Total	27 620 600	100,0	28 901 400	100,0	56 521 900	100,0

TABLE 2:

The ten leading underlying causes natural of deaths, 2014 to 2016

Causes of Death (based on ICD- 10)	2014			2015			2016		
	Rank	Number	%	Rank	Number	%	Rank	Number	%
Tuberculosis (A 15 – A 19)	1	30 495	8,3	1	33 063	6,3	3	29 513	6,5
Ill-defined and unknown causes of mortality (R 95 – R 99)							1	34 096	7,5
Diabetes mellitus (A10 – A 14)	3	23 966	5,0	2	25 070	5,4	4	25 255	5,5
Other forms of heart disease (E10 – R14)	4	22 928	4,8	4	22 215	4,8	5	23 515	5,2
Cerebrovascular diseases (I 60 –I 69)	2	24 131	5,1	3	A	5,0	6	23 137	5,1
Human immunodeficiency virus disease	6	22 729	4,6	5	21 926	4,8	7	21 830	4,8
Hypertensive diseases (J10 – J15)	7	18 719	3,9	6	20 570	4,6	8	19 960	4,4
Influenza and pneumonia (J09 J19)	5	18 319	3,9	7	19 443	4,2	9	19 638	4,3
Other viral diseases (J40 – J47)	9	14 508	3,1	8	16 907	3,5	10	16 577	3,6
Chronic lower respiratory disease (J40)	10	12 384	2,6	10	12 260	2,7	2	12 659	2,8

Adapted: www.statsa.gov.za

QUESTION 4.1

QUESTION 4.1

